



SINKS & TAPS 2021/2022





Over 70 years of passion

Smeg has been producing domestic appliances with the finest Italian design for more than 70 years, with a particular focus on aesthetics, ergonomics and functionality. Today Smeg, originally an acronym for Smalterie Metallurgiche Emiliane Guastalla indicating its initial activities in metal enamelling, is a world wide brand manufacturing a range of domestic and commercial appliances.

The Smeg portfolio includes a wide range of **sinks & taps, hand crafted in our factories in Italy**, to complete your kitchen. These have been carefully designed and constructed of **high quality materials**, resulting in a long working life. Smeg sinks & taps are available in different finishes and fittings, designed to best suit the layout of your kitchen.

From 1948

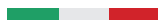

Made in Italy

MATERIALS & RANGES



STAINLESS STEEL

There is a clear reason why stainless steel is a popular choice for customers in their home. Its **versatile features** and **timeless finish** make it the perfect choice in any setting, whether it's a contemporary or traditional style kitchen.

Smeg's stainless steel sinks are made from **high quality 18/10 stainless steel**, resulting in a **resistance to rust and corrosion**. They have a **substantial thickness** and are **highly durable** which is why all our stainless steel sinks are provided with a life time warranty.*

Smeg's stainless steel range offers a selection of different sizes from **single bowl**, **1.5** or **double bowl** options with different installations to suit individual needs.

***30 Year Warranty on Stainless Steel Sinks**



COMPOSITE

Smeg composite sinks make the perfect choice for a modern kitchen, giving the colour scheme an edge over the classic stainless steel.

Composite sinks have the **appearance of natural stone** whilst retaining all the practical advantages of metal such as **resistance to high temperatures, impacts, and scratches**. They are **ergonomic** and **easy to clean** and our range benefits from **deeper than average bowl sizes**, providing a greater capacity and versatility. Smeg offers an array of different fittings and sizes. From **inset, undermount** and **top mount** installations to **single bowl** and **1.5 bowl options**, there is something for every kitchen.

30 Year Warranty on all Composite Sinks

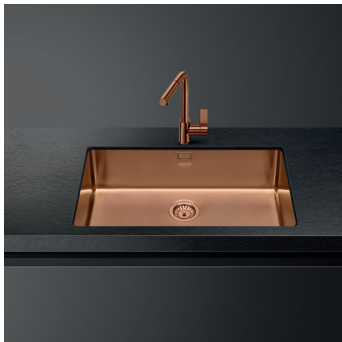

PVD

The PVD (Physical Vapour Deposition) process allows us to create stunning finishes, which are **durable** and **highly resistant** to wear and abrasion. The base of the sink is made of **high quality 18/10 stainless steel** with a PVD coating, which is available in **copper, gun metal or brass**. These colours complement other Smeg appliances, ensuring a seamless co-ordination in the kitchen.

2 Year Warranty on all PVD Sinks



The **Alba & Rigae** ranges are designed with classic curves in mind. These highly functional sinks are the perfect staple to complement any kitchen aesthetic.



The **Mira** range takes on the subtle and soft edges of contemporary design, with low radius corners and an array of finishings to really bring the kitchen to life.



The **Quadra** range boasts striking bold and clean lines, with perfectly square bowls that provide a modern finish in the kitchen.



TAPS

Choosing a sink is not complete until a tap has been selected to co-ordinate with the kitchen design. Smeg offers taps in many styles and finishes such as **brushed stainless steel, chrome, copper, gun metal** and **retro colours**.

The range includes **standard single lever mixers & dual flow mixers**, models with **pull out sprays** and **WRAS approved** taps. All Smeg taps come with Aerators which add air into the streams of water, reducing the litreage per minute from 15 to 6, saving you water and money.

Smeg are always looking for ways to further improve product efficiency. Our extensive tap range includes a **filtered water tap**, sure to add style as well as convenience to your kitchen.

2 Year Warranty on all Taps



WASTE DISPOSAL

Waste Disposal units are a must-have appliance for any kitchen. They are simple to use and an **environmentally friendly** way to **deal with domestic food waste**. At the touch of a button, food is **ground down into small particles** that are flushed away down the drain. It can deal with just about **any food within seconds** and fits discreetly underneath the sink. Smeg's range consists of three different sizes to suit each family's individual needs.

All Smeg sinks are fitted with a 3.5" waste outlet and are compatible with our waste disposal units.

SINKS





LYP861FR2

SINGLE BOWL SINGLE DRAINER
REVERSIBLE SINK, ST/STEEL

- Bowl depth: 1 x 154mm
- Bowl width: 1 x 330mm
- Drain: 3.5"
- 18/10 Stainless Steel
- Easy Installation
- Reversible
- Supplied with overflows, drainers, gaskets, fixing clips and dishwasher drain taps.



LYP102FR2

1.5 BOWL SINGLE DRAINER REVERSIBLE
INSET SINK, ST/STEEL

- Bowl depth: 1 x 163mm, 1 x 93mm
- Bowl width: 1 x 342mm, 1 x 170mm
- Drain: 3.5"
- 18/10 Stainless Steel
- Easy Installation
- Reversible
- Supplied with overflows, drainers, gaskets, fixing clips and dishwasher drain taps.



VS34/P3

ALBA SINGLE BOWL INSET SINK,
BRUSHED ST/STEEL

- Bowl depth: 1 x 210mm
- Bowl width: 1 x 340mm
- Drain: 3.5"
- 18/10 Stainless Steel
- Easy Installation
- Ultra low profile
- Supplied with overflows, drainers, gaskets, fixing clips and dishwasher drain taps.

'Stainless steel sinks are made from high quality 18/10 stainless steel, meaning they are resistant to rust and corrosion.'



LDR102-2

MIRA 1 3/4 BOWL REVERSIBLE INSET SINK WITH AUTOMATIC POP-UP, BRUSHED STAINLESS STEEL

- Bowl depths: 1 x 200mm, 1 x 150mm
- Bowl widths: 1 x 340mm, 1 x 147mm
- Drain: 3.5"
- 18/10 Stainless Steel
- Brushed Stainless steel finish
- Reversible
- Ultra low profile
- 15mm Radius
- Automatic Pop-up for 1 or 2 bowls
- Supplied with overflows, drainers, gaskets, fixing clips and dishwasher drain taps.



LDR861-2

MIRA SINGLE BOWL REVERSIBLE INSET SINK WITH AUTOMATIC POP-UP, BRUSHED ST/STEEL

- Bowl depth: 1 x 200mm
- Bowl width: 1 x 340mm
- Drain: 3.5"
- 18/10 Stainless Steel
- Brushed Stainless steel finish
- Reversible
- Ultra low profile
- 15mm Radius
- Automatic Pop-up for 1 or 2 bowls
- Supplied with overflows, drainers, gaskets, fixing clips and dishwasher drain taps.



'Stainless steel sinks are made from high quality 18/10 stainless steel, meaning they are resistant to rust and corrosion. The substantial thickness and low profile of the Mira range, make it the perfect fit for any kitchen.'



LZ102A2

RIGAE 1 ½ BOWL SINGLE REVERSIBLE DRAINER COMPOSITE INSET SINK, ANTHRACITE

- Bowl depth: 1 x 210mm, 1 x 168mm
- Bowl width: 1 x 420mm, 1 x 150mm
- Drain: 3.5"
- Reversible
- 50mm Radius
- Supplied with overflows, drainers, gaskets, fixing clips and dishwasher drain taps.

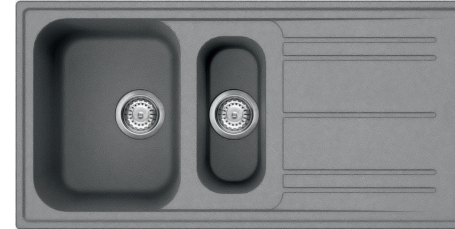

LZ102CT

RIGAE 1 ½ BOWL SINGLE REVERSIBLE DRAINER COMPOSITE INSET SINK, GREY

- Bowl depth: 1 x 210mm, 1 x 168mm
- Bowl width: 1 x 420mm, 1 x 150mm
- Drain: 3.5"
- Reversible
- 50mm Radius
- Supplied with overflows, drainers, gaskets, fixing clips and dishwasher drain taps.



LZ102B

RIGAE 1 ½ BOWL SINGLE REVERSIBLE DRAINER COMPOSITE INSET SINK, WHITE

- Bowl depth: 1 x 210mm, 1 x 168mm
- Bowl width: 1 x 420mm, 1 x 150mm
- Drain: 3.5"
- Reversible
- 50mm Radius
- Supplied with overflows, drainers, gaskets, fixing clips and dishwasher drain taps.

'Composite sinks have the appearance of natural stone whilst retaining all the practical advantages of resistance to high temperatures, impacts, and scratches. They are ergonomic, easy to clean and easy to install as they are reversible and can be easily mounted.'



VZP56CT

QUADRA SINGLE BOWL TOP MOUNT
OR UNDER MOUNT COMPOSITE SINK,
GREY

- Bowl depth: 1 x 200mm
- Bowl width: 1 x 500mm
- Drain: 3.5"
- Undermount & Topmount Installation
- 10mm Radius
- Ultra low profile
- Supplied with overflows, drainers, gaskets, fixing clips and dishwasher drain taps.



VZP56B

QUADRA SINGLE BOWL TOP MOUNT
OR UNDER MOUNT COMPOSITE SINK,
WHITE

- Bowl depth: 1 x 200mm
- Bowl width: 1 x 500mm
- Drain: 3.5"
- Undermount & Topmount Installation
- 10mm Radius
- Ultra low profile
- Supplied with overflows, drainers, gaskets, fixing clips and dishwasher drain taps.



VZP56N

QUADRA SINGLE BOWL TOP MOUNT
OR UNDER MOUNT COMPOSITE SINK,
BLACK

- Bowl depth: 1 x 200mm
- Bowl width: 1 x 500mm
- Drain: 3.5"
- Undermount & Topmount Installation
- 10mm Radius
- Ultra low profile
- Supplied with overflows, drainers, gaskets, fixing clips and dishwasher drain taps.



'These sinks offer maximum flexibility as they can be installed in two different ways; choose undermounted for a seamless finish or top mounted for quick installation. The single bowl design is ideal for smaller work top spaces and the extra deep 215ml bowl offers a greater capacity and versatility of use.'



VSTQ72-2

QUADRA SINGLE BOWL UNDERMOUNT SINK, BRUSHED ST/STEEL

- Bowl depths: 1 x 210mm
- Bowl widths: 1 x 720mm
- Drain: 3.5"
- 18/10 Stainless Steel
- Brushed Stainless Steel Finish
- Stainless Steel thickness 1mm
- 0 Radius
- Supplied with overflows, drainers, gaskets, fixing clips and dishwasher drain taps.



VSTQ50-2

QUADRA SINGLE BOWL UNDERMOUNT SINK, BRUSHED ST/STEEL

- Bowl depths: 1 x 210mm
- Bowl widths: 1 x 500mm
- Drain: 3.5"
- 18/10 Stainless Steel
- Brushed Stainless Steel Finish
- Stainless Steel thickness 1mm
- 0 Radius
- Supplied with overflows, drainers, gaskets, fixing clips and dishwasher drain taps.



VSTQ40-2

QUADRA SINGLE BOWL UNDERMOUNT SINK, BRUSHED ST/STEEL

- Bowl depths: 1 x 210mm
- Bowl widths: 1 x 400mm
- Drain: 3.5"
- 18/10 Stainless Steel
- Brushed Stainless Steel Finish
- Stainless Steel thickness 1mm
- 0 Radius
- Supplied with overflows, drainers, gaskets, fixing clips and dishwasher drain taps.

'Undermount sinks are widely chosen for installations with granite and composition worktops to give an understated but very practical and stylish appearance. The crisp bold lines and perfectly square bowls of the Quadra range, are ideal for those who wish to create an elegant and seamless finish in the kitchen.'



VSTR3434-2

MIRA DOUBLE BOWL UNDERMOUNT SINK,
BRUSHED ST/STEEL

- Bowl depths: 2 x 200mm
- Bowl widths: 2 x 340mm
- Drain: 3.5"
- 18/10 Stainless Steel
- Brushed Stainless Steel Finish
- Stainless Steel thickness 1mm
- 1.5mm Radius
- Supplied with overflows, drainers, gaskets, fixing clips and dishwasher drain taps.



VSTR4018-2

MIRA 1 3/4 BOWL UNDERMOUNT SINK,
BRUSHED ST/STEEL

- Bowl depths: 1 x 200mm, 1 x 156mm
- Bowl widths: 1 x 400mm, 1 x 180mm
- Drain: 3.5"
- 18/10 Stainless Steel
- Brushed Stainless Steel Finish
- Stainless Steel thickness 1mm
- 1.5mm Radius
- Supplied with overflows, drainers, gaskets, fixing clips and dishwasher drain taps.



VSTR50BRX

MIRA SINGLE BOWL UNDERMOUNT SINK
BRUSHED ST/STEEL & BRASS PVD

- Bowl depths: 1 x 200mm
- Bowl widths: 1 x 500mm
- Drain: 3.5"
- Brushed Stainless Steel Finish
- Stainless Steel thickness 1mm
- 1.5mm Radius
- Supplied with overflows, drainers, gaskets, fixing clips and dishwasher drain taps.



ALSO AVAILABLE:

VSTR50DKX - Gun metal grey PVD
VSTR50CUX - Copper PVD



VSTR34BRX

MIRA SINGLE BOWL UNDERMOUNT SINK
BRUSHED ST/STEEL & BRASS PVD

- Bowl depths: 1 x 200mm
- Bowl widths: 1 x 340mm
- Drain: 3.5"
- Brushed Stainless Steel Finish
- Stainless Steel thickness 1mm
- 1.5mm Radius
- Supplied with overflows, drainers, gaskets, fixing clips and dishwasher drain taps.



ALSO AVAILABLE:

VSTR34DKX - Gun metal Grey PVD
VSTR34CUX - Copper PVD



VFU50SFR

MIRA SINGLE BOWL TRIPLE INSTALLATION SINK,
BRUSHED ST/STEEL

- Bowl depths: 1 x 200mm
- Bowl widths: 1 x 500mm
- Drain: 3.5"
- 18/10 Stainless Steel
- Brushed Stainless Steel Finish
- Stainless Steel thickness 1mm
- **Undermount, Flush Fit & Topmount Installation**
- 15mm Radius
- Supplied with overflows, drainers, gaskets, fixing clips and dishwasher drain taps.



VFU34SFR

MIRA SINGLE BOWL TRIPLE INSTALLATION SINK,
BRUSHED ST/STEEL

- Bowl depths: 1 x 200mm
- Bowl widths: 1 x 340mm
- Drain: 3.5"
- 18/10 Stainless Steel
- Brushed Stainless Steel Finish
- Stainless Steel thickness 1mm
- **Undermount, Flush Fit & Topmount Installation**
- 15mm Radius
- Supplied with overflows, drainers, gaskets, fixing clips and dishwasher drain taps.



'These sinks offer maximum flexibility as they can be installed in three different ways; choose undermounted for a seamless finish, flush fit and top mounted for quick installation. The single bowl design is ideal for smaller work top spaces.'



UM4545

ALBA DOUBLE BOWL UNDERMOUNT SINK,
BRUSHED ST/STEEL

- Bowl depths: 2 x 180mm
- Bowl widths: 2 x 450mm
- Drain: 3.5"
- 18/10 Stainless Steel
- Brushed Stainless Steel Finish
- Stainless Steel thickness 0.7mm
- 72mm Radius
- Supplied with overflows, drainers, gaskets, fixing clips and dishwasher drain taps.



UM3416-1

ALBA 1 ½ BOWL UNDERMOUNT SINK,
BRUSHED ST/STEEL

- Bowl depths: 1 x 180mm, 1 x 130mm
- Bowl widths: 1 x 340mm, 1 x 165mm
- Drain: 3.5"
- 18/10 Stainless Steel
- Brushed Stainless Steel Finish
- Stainless Steel thickness 0.7mm
- 72mm Radius
- Supplied with overflows, drainers, gaskets, fixing clips and dishwasher drain taps.



UM45

ALBA SINGLE BOWL UNDERMOUNT
SINK, BRUSHED ST/STEEL

- Bowl depths: 1 x 180mm
- Bowl widths: 1 x 450mm
- Drain: 3.5"
- 18/10 Stainless Steel
- Brushed Stainless Steel Finish
- Stainless Steel thickness 0.7mm
- 72mm Radius
- Supplied with overflows, drainers, gaskets, fixing clips and dishwasher drain taps.



UM40

ALBA SINGLE BOWL UNDERMOUNT
SINK, BRUSHED ST/STEEL

- Bowl depths: 1 x 180mm
- Bowl widths: 1 x 400mm
- Drain: 3.5"
- 18/10 Stainless Steel
- Brushed Stainless Steel Finish
- Stainless Steel thickness 0.7mm
- 72mm Radius
- Supplied with overflows, drainers, gaskets, fixing clips and dishwasher drain taps.



UM30

ALBA SINGLE BOWL UNDERMOUNT
SINK, BRUSHED ST/STEEL

- Bowl depths: 1 x 180mm
- Bowl widths: 1 x 300mm
- Drain: 3.5"
- 18/10 Stainless Steel
- Brushed Stainless Steel Finish
- Stainless Steel thickness 0.7mm
- 72mm Radius
- Supplied with overflows, drainers, gaskets, fixing clips and dishwasher drain taps.



SINK & TAP ACCESSORIES





KITFD050UK

WASTE DISPOSAL UNIT WITH
0.5 HORSEPOWER MOTOR

- Continuous feed
- Air Switch
- Fits all sinks with a 3.5" waste outlet



KITFD075UK

WASTE DISPOSAL UNIT WITH
0.75 HORSEPOWER MOTOR



KITFD100UK

WASTE DISPOSAL UNIT WITH
1 HORSEPOWER MOTOR



STABMIX

UNIVERSAL TAP BRACE

- Universal tap brace to add extra stability to tap and allow easy swivel movements between bowls.

WASTE DISPOSAL UNITS

A must-have appliance for the modern kitchen, waste disposal units are a simple and environmentally friendly way to deal with food waste. At the touch of a button, food is ground down into small particles that are then flushed away down the drain. It can deal with just about any food, including meat bones, within seconds, and fits discreetly underneath the sink.

In order to select the most suitable waste disposal unit for your household, consider that the larger the motor, the more powerful the waste disposal is and the more it will be able to do.

Customers should consider the amount of waste they want to get rid of. As a guide, households of 1-2 people would find a 0.5 horsepower motor sufficient, whereas with larger families a 1 or 1.5 horsepower motor would be more suitable.



TAPS





FILTERED WATER TAP

The MAP99CR provides not only cold and hot water, but also **filtered water**. Buying expensive and non-environmentally friendly bottled water can become a thing of the past. You can now enjoy fresh, superior quality water directly from the tap as soon as you need it.

The filtration cartridge **removes chlorine, limescale and other impurities** found within water for **healthier and safer results**.



MAP99CR

3 IN 1 FILTERED WATER & STANDARD HOT & COLD
TAP
CHROME

- Handle for filtered water supply
- Single jet spray
- Spout swivels 360°
- Ceramic disc
- Aerator with double flow for filtered water
- Minimum water pressure 0.5 bar



**MD22CUX**

SINGLE LEVER MIXER TAP WITH PULL OUT
SPRAY NOZZLE
COPPER PVD

- Single lever mixer
- Single jet spray
- Pull out spout-spray
- Spout swivels 360°
- Ceramic disc
- Aerator
- Minimum water pressure 0.5 bar

ALSO AVAILABLE:

MD22DKX - Gun metal grey PVD

**MID9CR**

SINGLE LEVER MIXER TAP WITH FLEXIBLE
PULL OUT SPRAY NOZZLE
CHROME

- Single lever mixer
- Double jet spray
- Flexible pull out spray nozzle with clip in option
- Spout swivels 360°
- Ceramic disc
- Aerator
- Minimum water pressure 0.5 bar



ALSO AVAILABLE:

MDF50BL - Black

MDF50CR - Cream

MDF50PB - Pastel Blue

MDF50PG - Pastel Green

MDF50WH - White

MDF50SS - St/Steel

MDF50RD

50'S RETRO SINGLE LEVER MIXER TAP
WITH FLEXIBLE PULL OUT SPRAY NOZZLE
RED & CHROME

- Single lever mixer
- Single jet spray
- Flexible pull out spray nozzle with clip in option
- Spout swivels 360°
- Ceramic disc
- Aerator
- Minimum water pressure 0.5 bar

**MID2MN**

SINGLE LEVER MIXER TAP,
BLACK

- Single lever mixer
- Swivel spout 180°
- Ceramic disc
- Aerator
- Minimum water pressure 1 bar



**MID1CR**

SINGLE LEVER MIXER TAP WITH PULL OUT
SPRAY NOZZLE
CHROME

- Single lever mixer
- Single jet spray
- Pull out spout-spray
- Spout swivels 180°
- Ceramic disc
- Aerator
- Minimum water pressure 1 bar

**MIRO-SS**

DUAL LEVER MIXER TAP
BRUSHED ST/STEEL

- Dual lever mixer
- Single jet spray
- Spout swivels
- Aerator
- Minimum water pressure 0.3 bar

ALSO AVAILABLE:
MIRO-CR - Chrome

**MODENA**

DUAL LEVER MIXER TAP
CHROME

- Dual flow mixer tap
- Swivel spout with anti-splash
- Braided stainless steel connection hoses
- Aerator
- Minimum water pressure 0.5 bar

**MF11CR3**

SINGLE LEVER MIXER TAP
CHROME

- Single lever mixer with curved neck
- Swivel spout 360°
- Aerator
- Ceramic disc cartridge
- Braided stainless steel connection hoses
- Minimum water pressure 0.5 bar

SINK & TAP BUNDLES

CLASSIC BUNDLE



PACK CODE: LYP10ROME2

LYP102FR2

- Bowl depths: 1 x 163mm, 1 x 93mm
- Bowl widths: 1 x 342mm, 1 x 170mm
- Drain: 3.5"

ROME

- Single lever mixer
- Swivel spout
- Aerator
- Minimum water pressure 0.3 bar



PACK CODE: LYP8ROME2

LYP861FR2

- Bowl depth: 1 x 154mm
- Bowl width: 1 x 330mm
- Drain: 3.5"

ROME

- Single lever mixer
- Swivel spout
- Aerator
- Minimum water pressure 0.3 bar

MIRA INSET BUNDLE



PACK CODE: LDR10MIROS

LDR102-2

- Bowl depth: 1 x 200mm, 1 x 150mm
- Bowl width: 1 x 340mm, 1 x 147mm
- Drain: 3.5"

MIRO-SS

- Dual lever mixer
- Single jet spray
- Spout swivels
- Aerator
- Minimum water pressure 0.3 bar



PACK CODE: LDR86MIROS

LDR861-2

- Bowl depth: 1 x 200mm
- Bowl width: 1 x 340mm
- Drain: 3.5"

MIRO-SS

- Dual lever mixer
- Single jet spray
- Spout swivels
- Aerator
- Minimum water pressure 0.3 bar

ALBA UNDERMOUNT BUNDLE



+



PACK CODE: UMMIRO

UM3416-1

- Bowl depths: 1 x 180mm, 1 x 130mm
- Bowl widths: 1 x 340mm, 1 x 165mm
- Drain: 3.5"

MIRO-CR

- Dual lever mixer
- Single jet spray
- Spout swivels
- Aerator
- Minimum water pressure 0.3 bar

QUADRA BUNDLE



PACK CODE: VZP56CMID1 (Grey Sink)
PACK CODE: VZP56BMID1 (White Sink)
PACK CODE: VZP56NMID1 (Black Sink)

VZP56CT - Grey
VZP56B - White
VZP56N - Black

- Bowl depth: 1 x 200mm
- Bowl width: 1 x 500mm
- Drain: 3.5"

MID1CR

- Single lever mixer
- Single jet spray
- Pull out spout-spray
- Spout swivels 180°
- Ceramic disc
- Aerator
- Minimum water pressure 1 bar



+

MIRA UNDERMOUNT BUNDLE



PACK CODE: VSTR40MID

VSTR4018-2

- Bowl depths: 1 x 200mm, 1 x 156mm
- Bowl widths: 1 x 400mm, 1 x 180mm
- Drain: 3.5"

MID1CR

- Single lever mixer
- Single jet spray
- Pull out spout-spray
- Spout swivels 180°
- Ceramic disc
- Aerator
- Minimum water pressure 1 bar

PACK CODE: VFU50MID



VFU50SFR

- Bowl depth: 1 x 200mm
- Bowl width: 1 x 500mm
- Drain: 3.5"

MID1CR

- Single lever mixer
- Single jet spray
- Pull out spout-spray
- Spout swivels 180°
- Ceramic disc
- Aerator
- Minimum water pressure 1 bar

PVD BUNDLE



PACK CODE: VSTR50DMD

VSTR50DKX

- Bowl depths: 1 x 200mm
- Bowl widths: 1 x 500mm
- Drain: 3.5"

MD22DKX

- Single lever mixer
- Single jet spray
- Pull out spout-spray
- Spout swivels 360°
- Ceramic disc
- Aerator
- Minimum water pressure 0.5 bar



PACK CODE: VSTR50CMD

VSTR50CUX

- Bowl depths: 1 x 200mm
- Bowl widths: 1 x 500mm
- Drain: 3.5"

MD22CUX

- Single lever mixer
- Single jet spray
- Pull out spout-spray
- Spout swivels 360°
- Ceramic disc
- Aerator
- Minimum water pressure 0.5 bar

TECHNICAL DRAWINGS

STAINLESS STEEL INSET SINKS

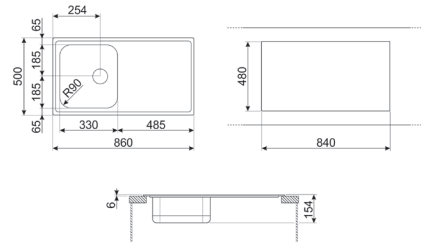

LYP861FR2

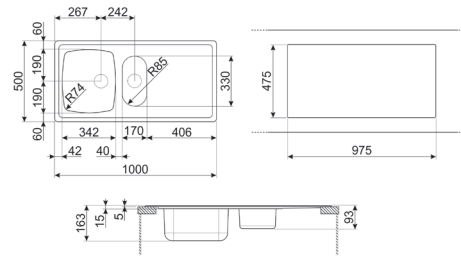

LYP102FR2

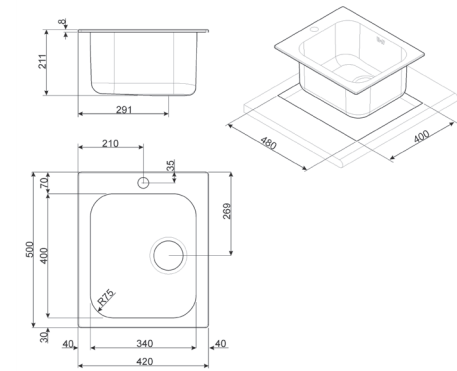

VS34/P3

MIRA STAINLESS STEEL INSET SINKS

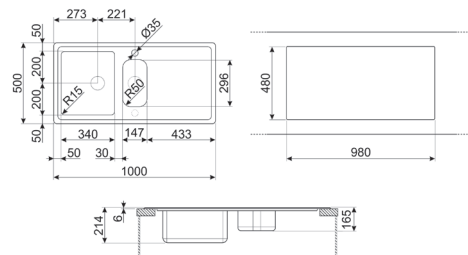

LDR102-2

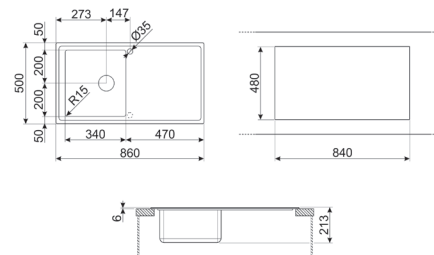

LDR861-2

RIGAE INSET SINKS

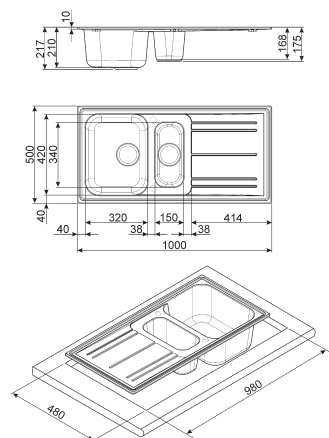

LZ102A2/LZ102B/LZ102CT

QUADRA TOPMOUNT & UNDERMOUNT SINKS

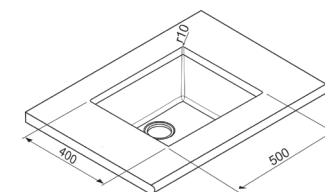
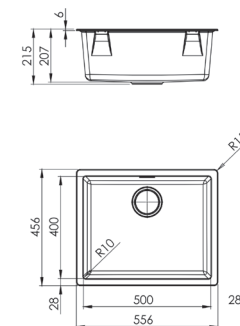
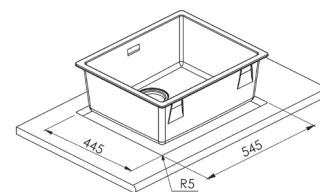
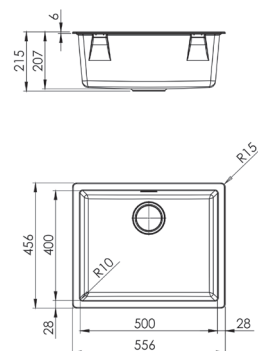

VZP56CT/VZP56B/VZP56N

QUADRA UNDERMOUNT SINKS

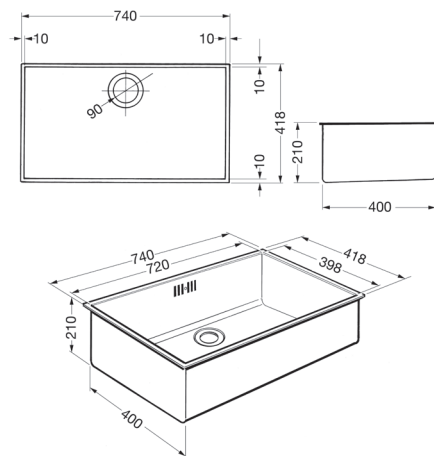

VSTQ72-2

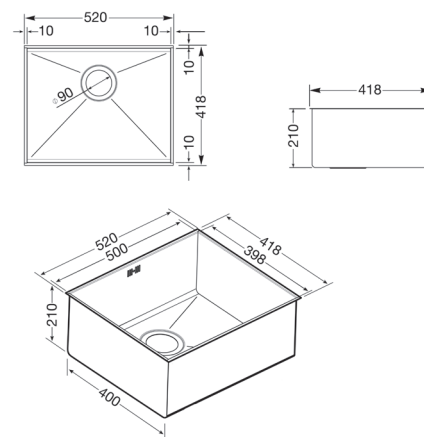

VSTQ50-2

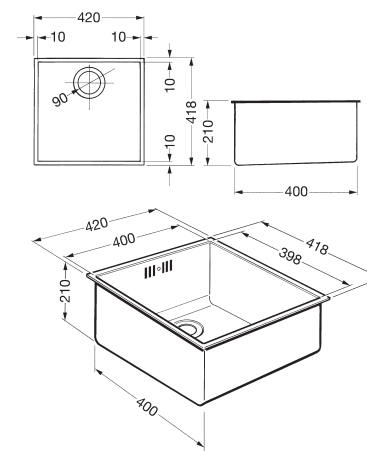

VSTQ40-2

MIRA STAINLESS STEEL & PVD UNDERMOUNT SINKS

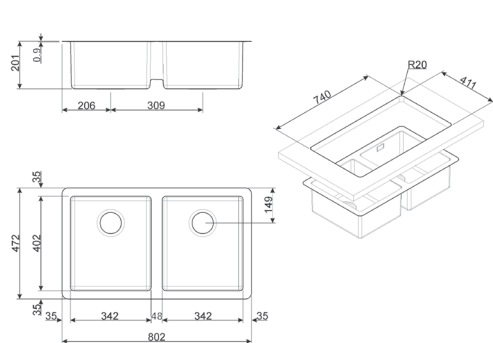

VSTR3434-2

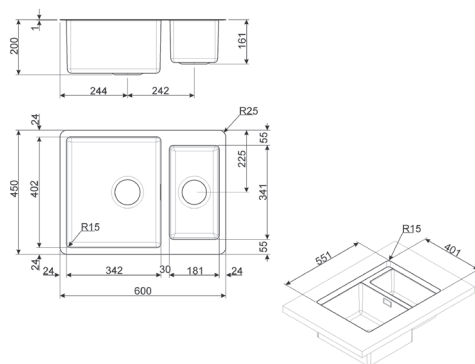

VSTR4018-2

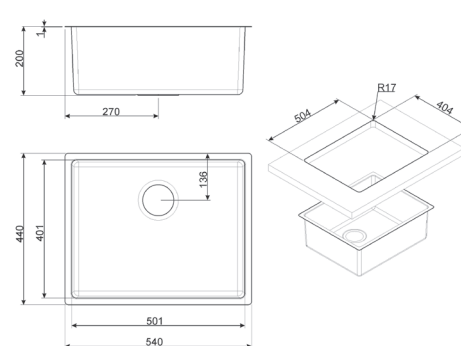

VFU50SFR/VSTR50DKX/VSTR50CUX

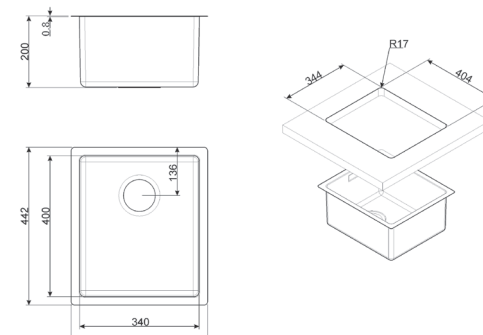

VFU345FR/VSTR34DKX/VSTR34CUX

MIRA TRIPLE INSTALLATION SINKS

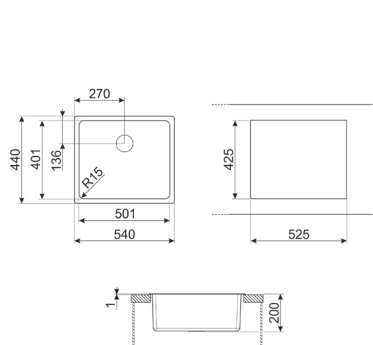

VFU50SFR

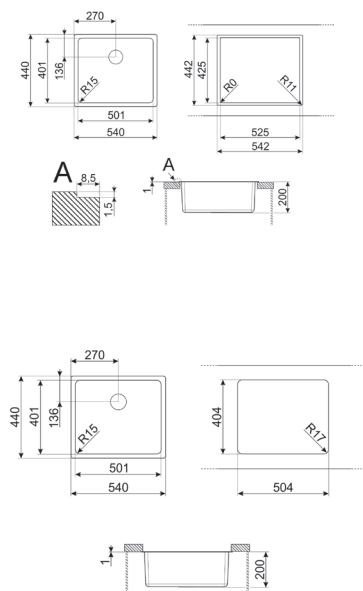

VFU34SFR

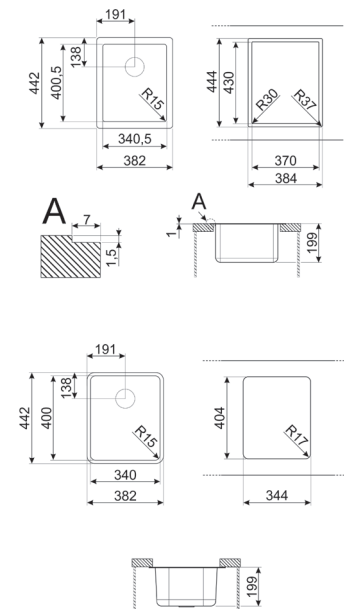

ALBA STAINLESS STEEL UNDERMOUNT SINKS

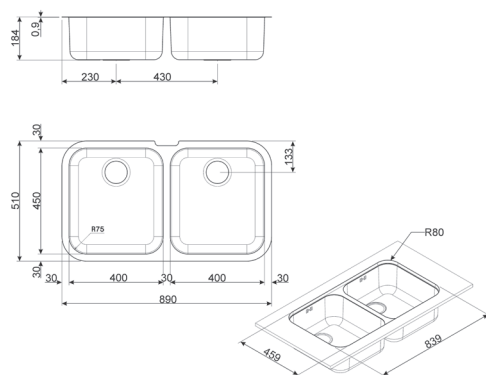

UM4545

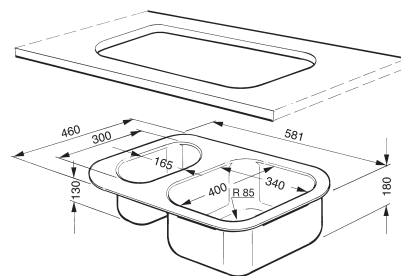

UM3416-1

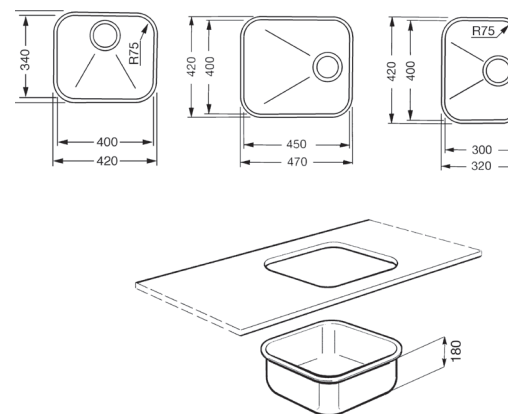

UM45/UM40/UM30

WASTE DISPOSAL UNITS

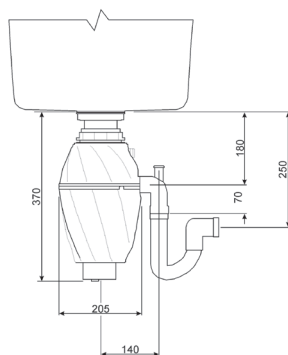

KITFD050UK

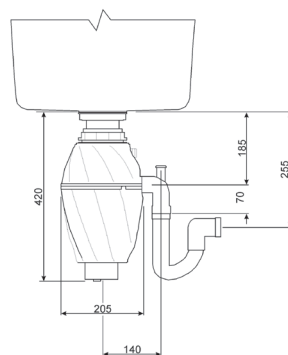

KITFD075UK

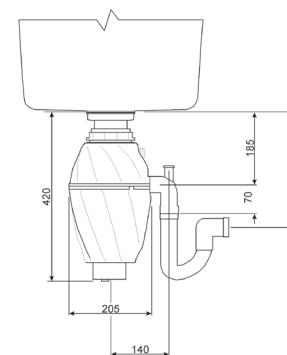

KITFD100UK

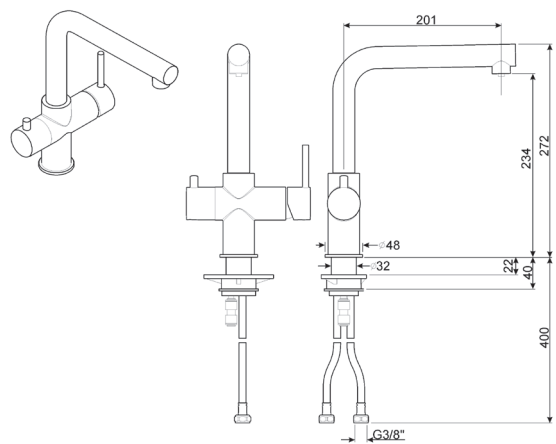

MAP99CR

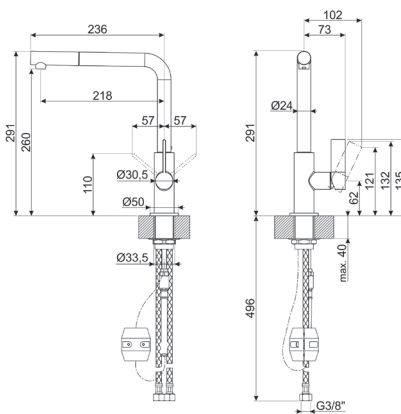

MD22CUX/MD22DKX

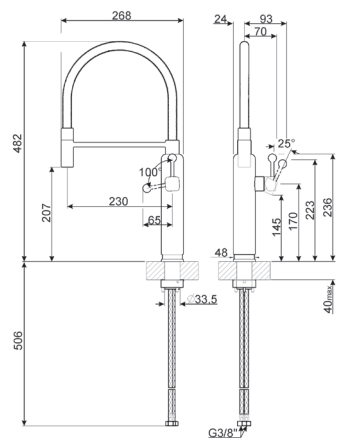

MDF50RD/BL/CR/PB/PG/WH/SS

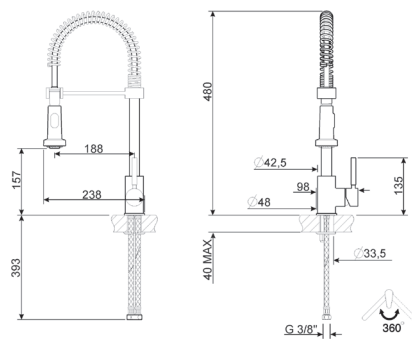

MID9CR

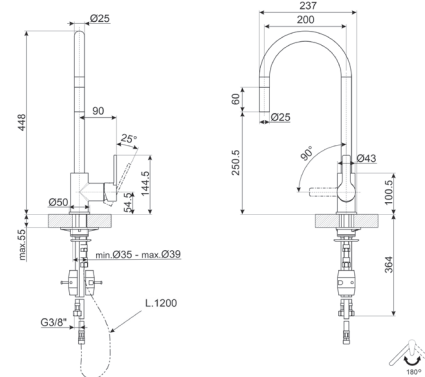

MID2MN

TAPS

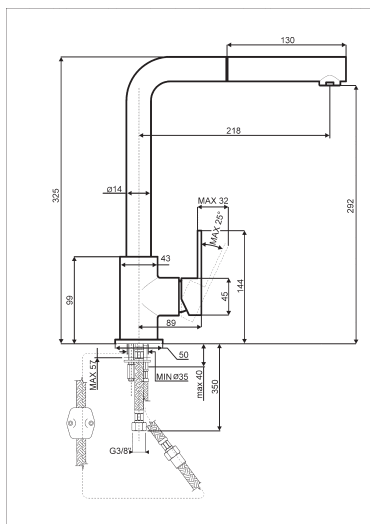

MID1CR

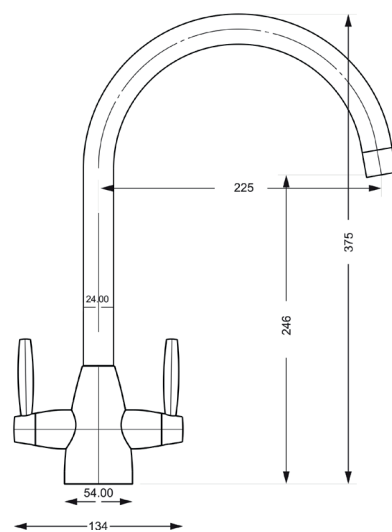

MIRO-SS/MIRO-CR

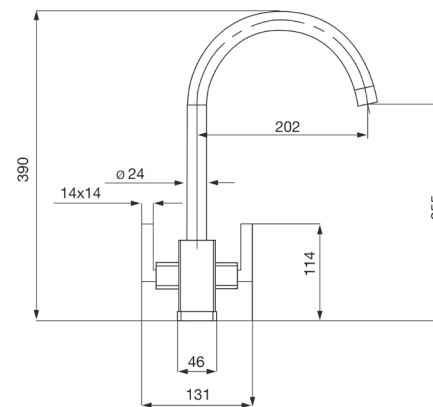

MODENA

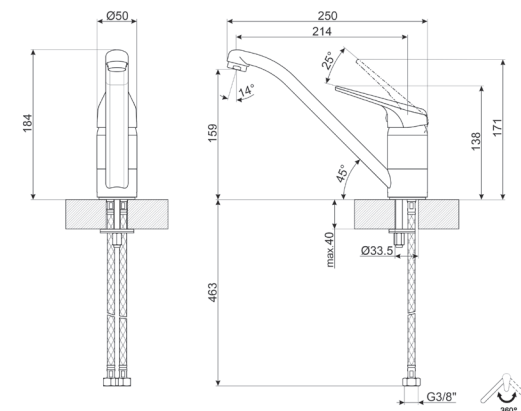

MF11CR3

SYMBOLS KEY



Smeg taps with energy saving cartridges only dispense cold water when depressing centrally. To obtain hot water simply turn the lever further left.



Selected Smeg taps offer water saving cartridges which reduce water consumption by 50%, sufficient for cooking and cleaning activities.



Selected Smeg taps are WRAS approved, meaning they have been given approval by the representatives of water suppliers and is accepted by every water supplied in the UK.

SINK & TAP PARTS WARRANTY

Smeg appliances are made from long lasting high quality materials however, for piece of mind, Smeg offer a lifetime parts warranty (30 years) on sinks (excluding PVD coating sinks which have a 2 year parts warranty) and 2 years parts warranty on taps.

Whereas every effort has been made to ensure that the information and images contained in our literature are correct at the time of going to print, this brochure should not be regarded as an infallible guide to current specification, nor does it constitute an offer for sale of any particular product.

SMEG (UK) Limited

The Magna Building, Wyndyke Furlong
Abingdon, Oxfordshire, OX14 1DZ

Information line

Tel: 0344 5579907

Trade Enquiries

Tel: 0344 5570070

Service & Spare Parts

Tel: 0344 5579907

www.smeguk.com

